

2J6551B

2J6551BG

(DATASHEET)

Type
Frequencies

Combined antenna
AMPS (850 MHz)
GSM (900 MHz)
DCS (1800 MHz)
PCS (1900 MHz)
3G (UMTS 2.1 GHz)

GPS (1575.42 MHz)
GALILEO L1 (1575.42 MHz)
GLONASS (1592 - 1610 MHz)

WIFI / BLUETOOTH (2.4 GHz)

Mounting
Revision

IRIDIUM (1.616 - 1.626 GHz)
Body Mount
00



P. Tipul

1. SPECIFICATION

1.1. Electrical Specifications

Mobile (Cable 1)

Frequencies	AMPS (850 MHz) GSM (900 MHz) DCS (1800 MHz) PCS (1900 MHz) 3G (UMTS 2.1 GHz)
Impedance	50 Ohms
Polarization	Horizontal
Gain	2dBi Max.
VSWR	<2.5:1
Power handling	25W

Navigation (Cable 2)

	2J6551B	2J6551BG
Frequencies	GPS (1575.42 MHz) GALILEO L1 (1575.42 MHz)	GPS (1575.42 MHz) GALILEO L1 (1575.42 MHz) GLONASS (1592 - 1610 MHz)
Impedance	50 Ohms	
Noise figure	1.2 dB	
Patch gain	2-3 dBiC	
Patch size	25 x 25 x 4 mm	
Polarization	RHCP	
LNA Gain	23 dB at 3V; 24 dB at 5V	
VSWR	<1.5:1	
Voltage supply	2.7 V to 5.5 V	
Current	15 mA to 25 mA	
Power (max.)	138 mW	

Wifi (Cable 3)

Frequencies	WIFI / BLUETOOTH (2.4 GHz)
Impedance	50 Ohms
Polarization	Vertical
Gain	2 dBi
VSWR	<2:1

Iridium (Cable 4)

Frequencies	IRIDIUM (1.616 - 1.626 GHz)
Impedance	50 Ohms
Patch gain	3 dBiC
Patch size	35 x 35 x 3 mm
Polarization	RHCP
VSWR	<1.5:1

1.2. General Specifications

Certificates	IP67, IK09, IP69K
Operating temperature	40°C to +85°C

1.3. Connection Specifications

Cable 1 (Mobile):
Connector type: SMA
Cable: RG174U
Cable length: 300 cm

Cable 2 (Navigation):
Connector type: SMA
Cable: RG174U
Cable length: 300 cm

Cable 3 (Wifi):
Connector type: SMA
Cable: RG174U
Cable length: 300 cm

Cable 4 (Iridium):
Connector type: SMA
Cable: LMR100
Cable length: 300 cm

For different cable length and connector type ask our sales team.

1.4. Mechanical Specifications and Dimensions

Material: Lid: HI ABS / Base: Zamak / Gasket: TPE
Max. dimensions: 146mm x 32mm (dimensions after mounting)
Colour: Black/ Green/ White (for different colours please ask our sales team)

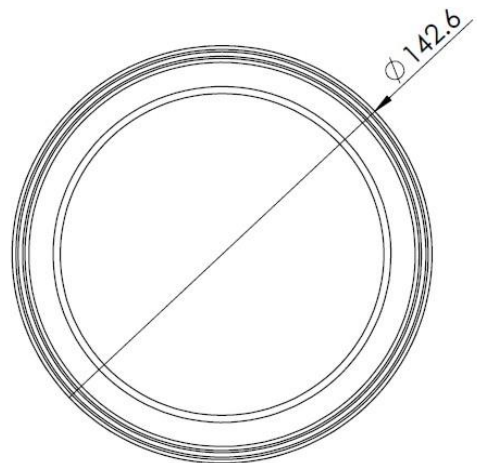
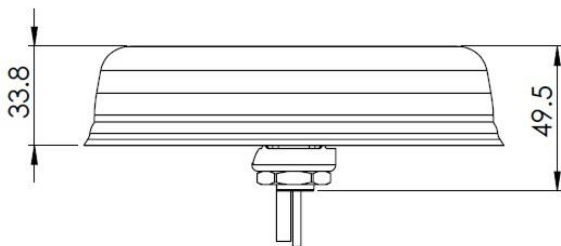

2. MEASUREMENT

- Tested with 3m cable length

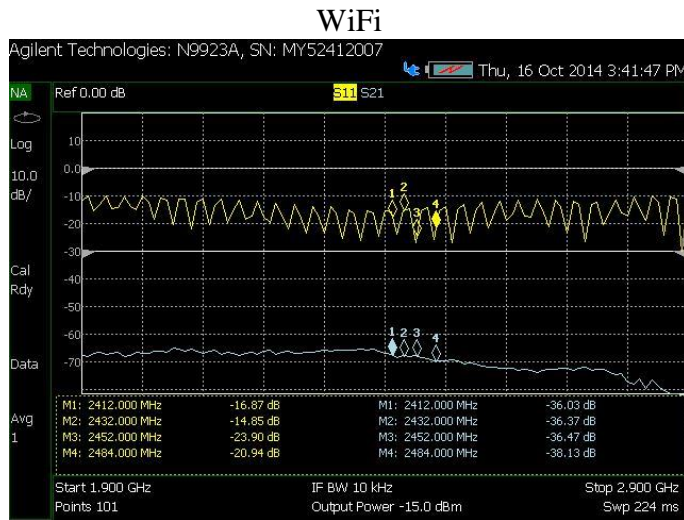

Figure 1 - S11 and S21



Figure 2 - S11

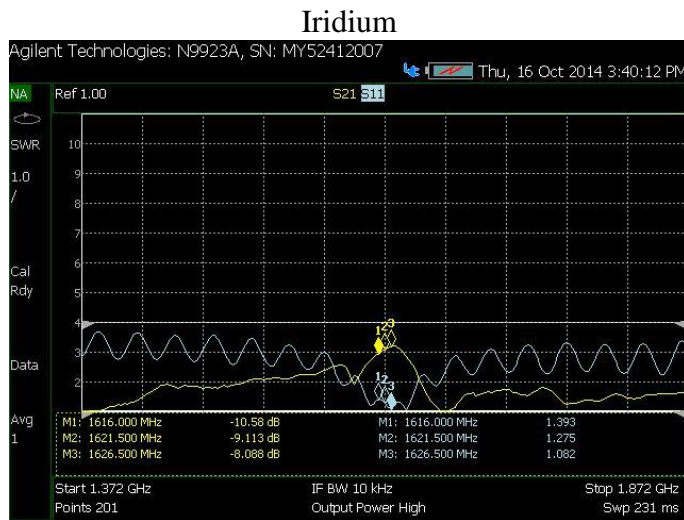

Figure 3 - S11 and S21 with LMR 100

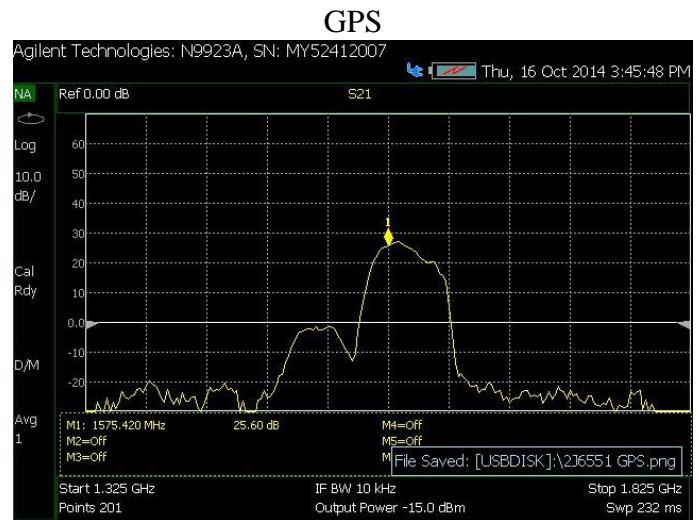

Figure 4 - S21 gain measured at 3V